

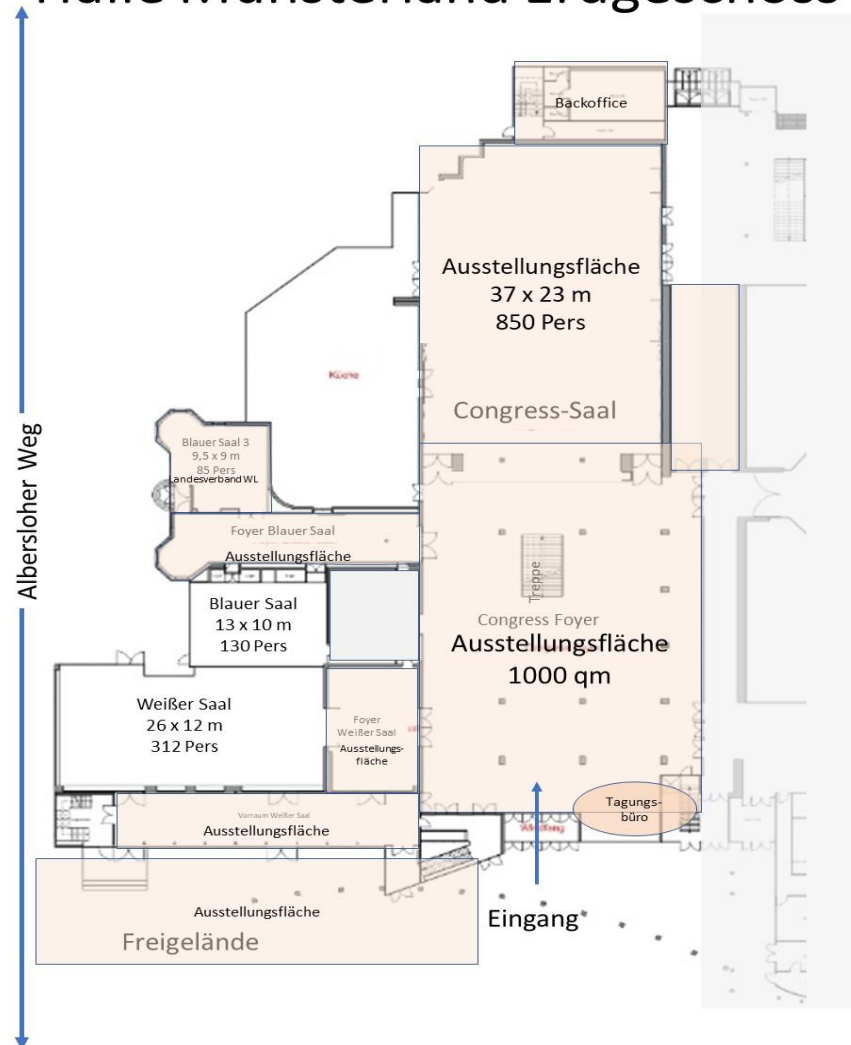

Registration beekeeping exhibition 2019

Area plan Halle Münsterland ground floor
(subject to changes)

Halle Münsterland Erdgeschoss



Area

Congress Hall

additional information

37 x 23 m 851 qm
exhibits in variable sizes

Foyer ground floor

1.000 qm
ground floor entrance, ticket office, information office, bistro, Via Miele
small exhibits

Open-air exh. ground

Via Miele, Bienenweide etc.

Adj. room White hall

2-3 exhibits

Foyer White hall

small exhibits, Apis e.V.

Blue hall 3:

small exhibits, beekeeping association

Foyer Blue hall

2-3 exhibits



Halle Münsterland Obergeschoss

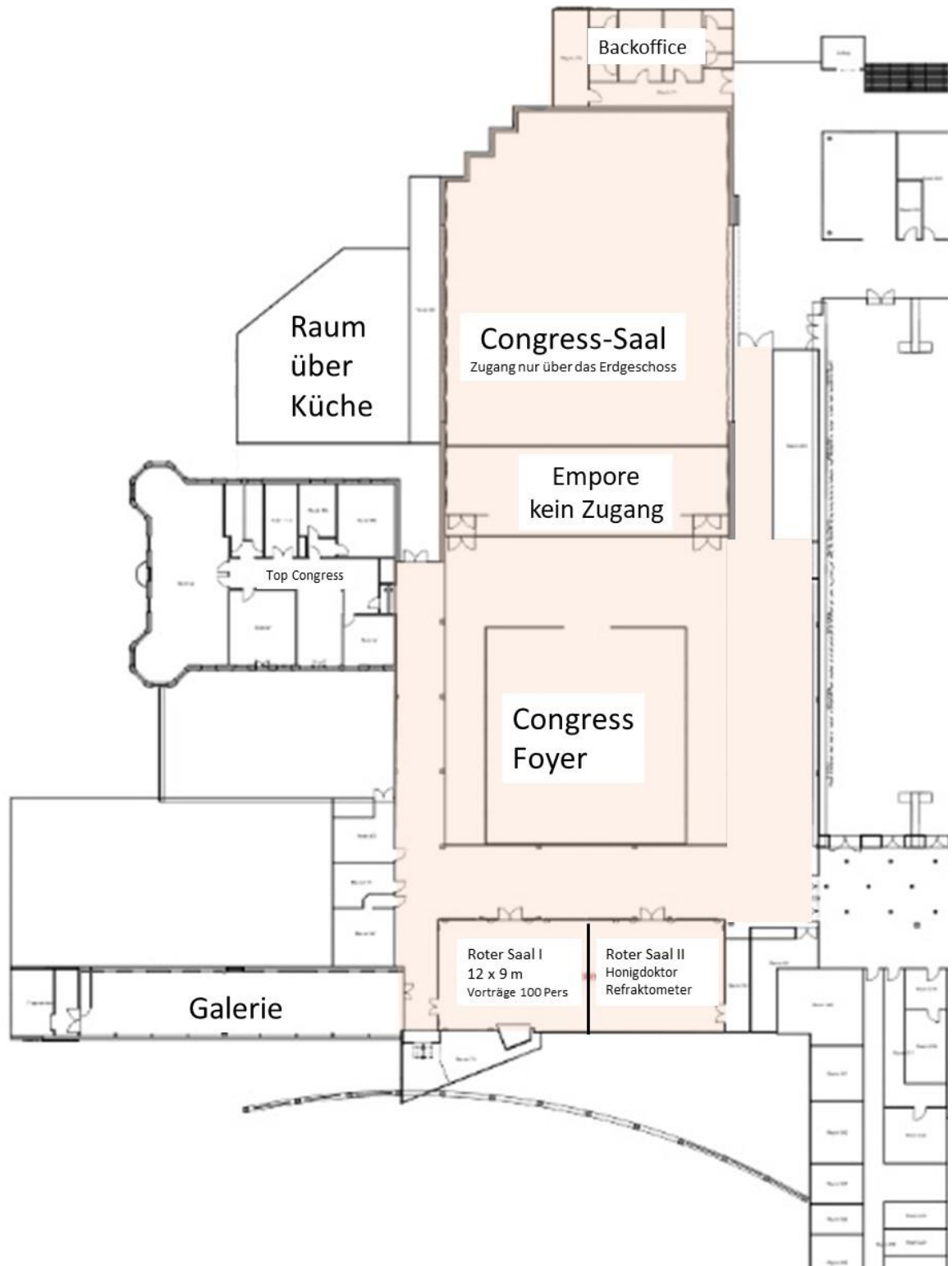

Foyer first floor
Red hall II:

small exhibits
Honigdoktor and Kalibrierung Refraktometer

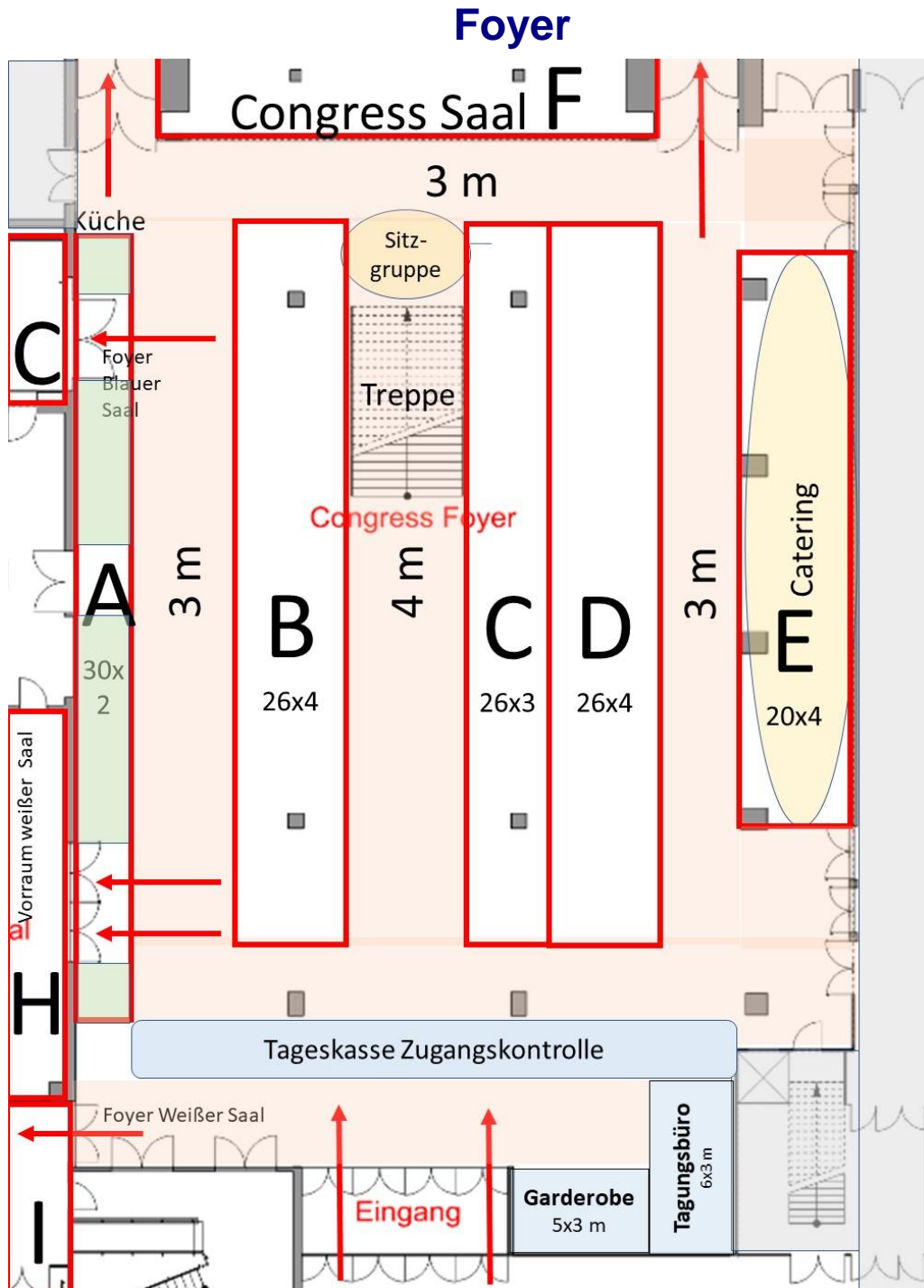

Area	additional information
Area A	30 x 2 m, back wall, ceiling 2,80 m
Area B	26 x 4 m, 4 m depth, stairway
Area C	26 x 3 m, 3 m depth, no back wall, stairway
Area D	25 x 4 m, 4 m depth, no back wall
Area E	20 x 4 m, catering, back wall, ceiling 2,80 m



Congress hall

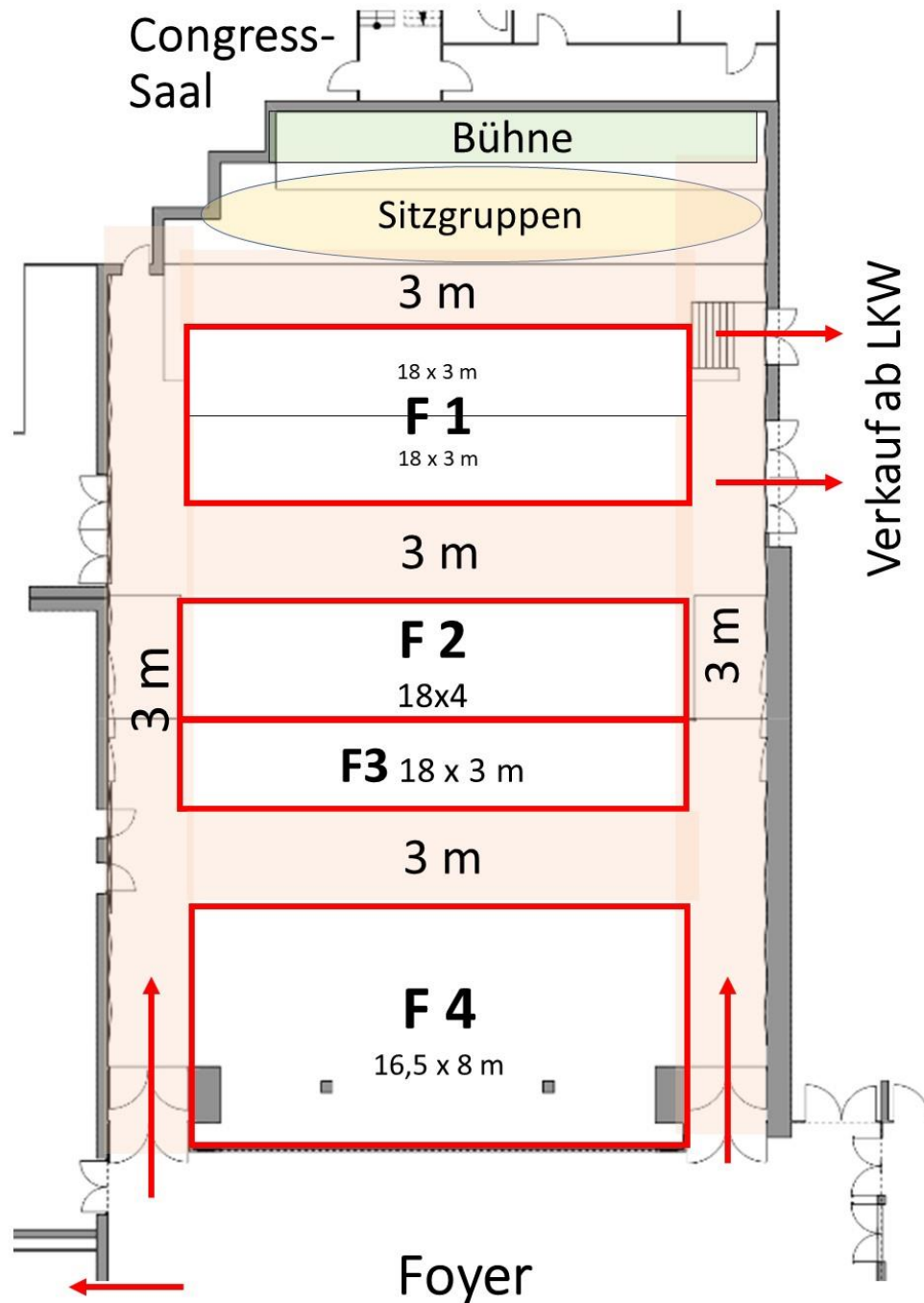

Delivery of supplies on ground level from parking area P2 south
Sales directly from a trailer possible through exits to parking area P2 south

- F1** 2 areas, 18 x 6 m, terminal exhibits 6 m width, variable depth
- F2** 18 x 4 m, terminal exhibits 7 m width, variable depth
- F3** 18 x 3 m, terminal exhibits 7 m width, variable depth
- F4** 9,5 x 8 m block exhibit



Foyer First floor

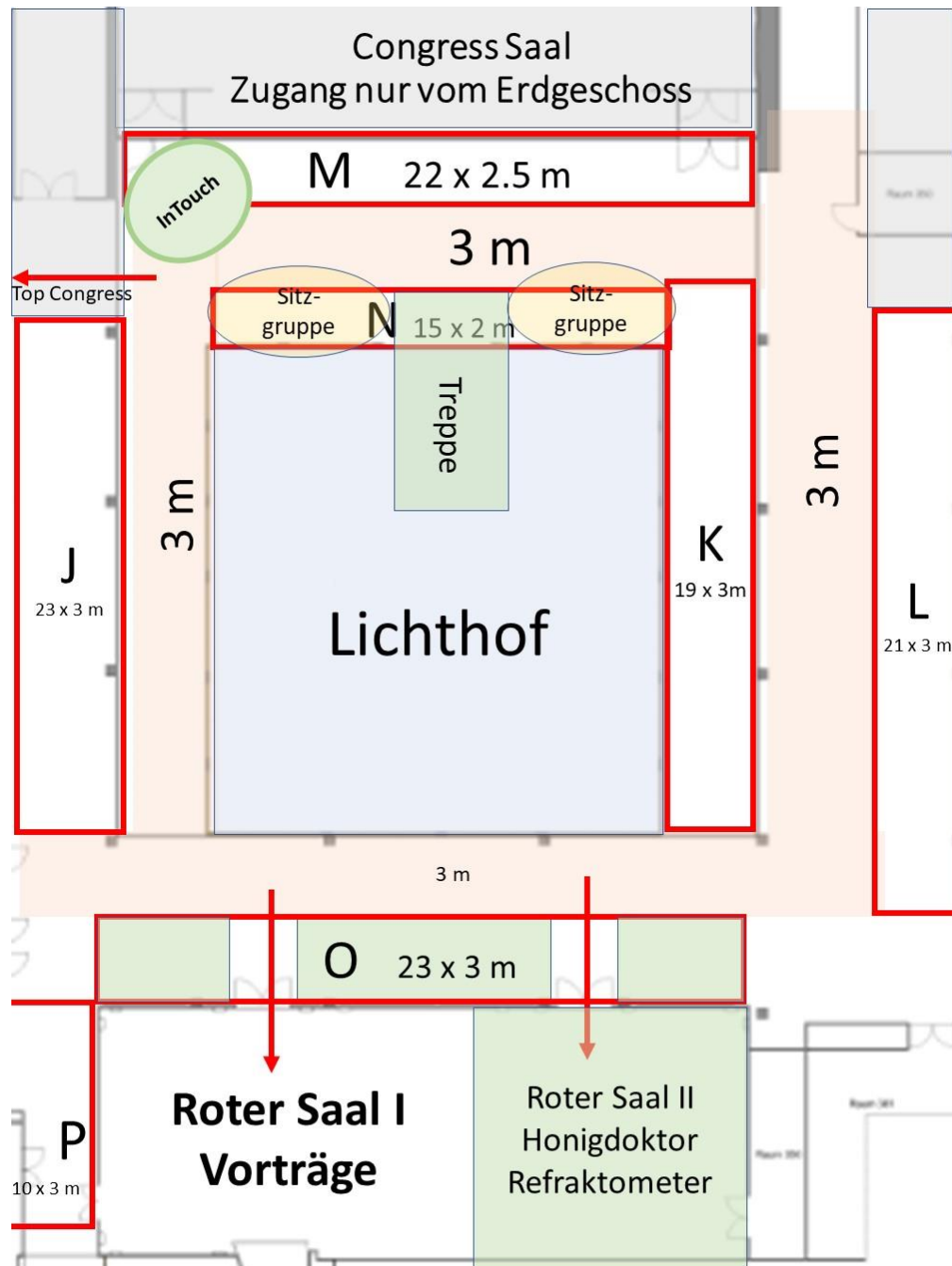

Exhibits in the galleries around the central area, view onto the ground floor, entrance to the Red hall and Top congress. Entry via lifts and central stairway.

Area Information

- J** 23 x 3 m exhibits, 3 m depth, back wall
- K** 19 x 3 m, exhibits 3 m depth, back wall, handrail
- L** 21 x 3 m, exhibits, 3 m depth, back wall
- M** 22 x 2,5m, exhibits ca. 2,5 m depth, back wall
- N** 15 x 2 m, exhibits 2 m depth, back wall, handrail,
- O** 23 x 3 m, exhibits 3 m depth, back wall
- P** 10 x 3 m, adjoining hallway



Ground floor adjoining rooms

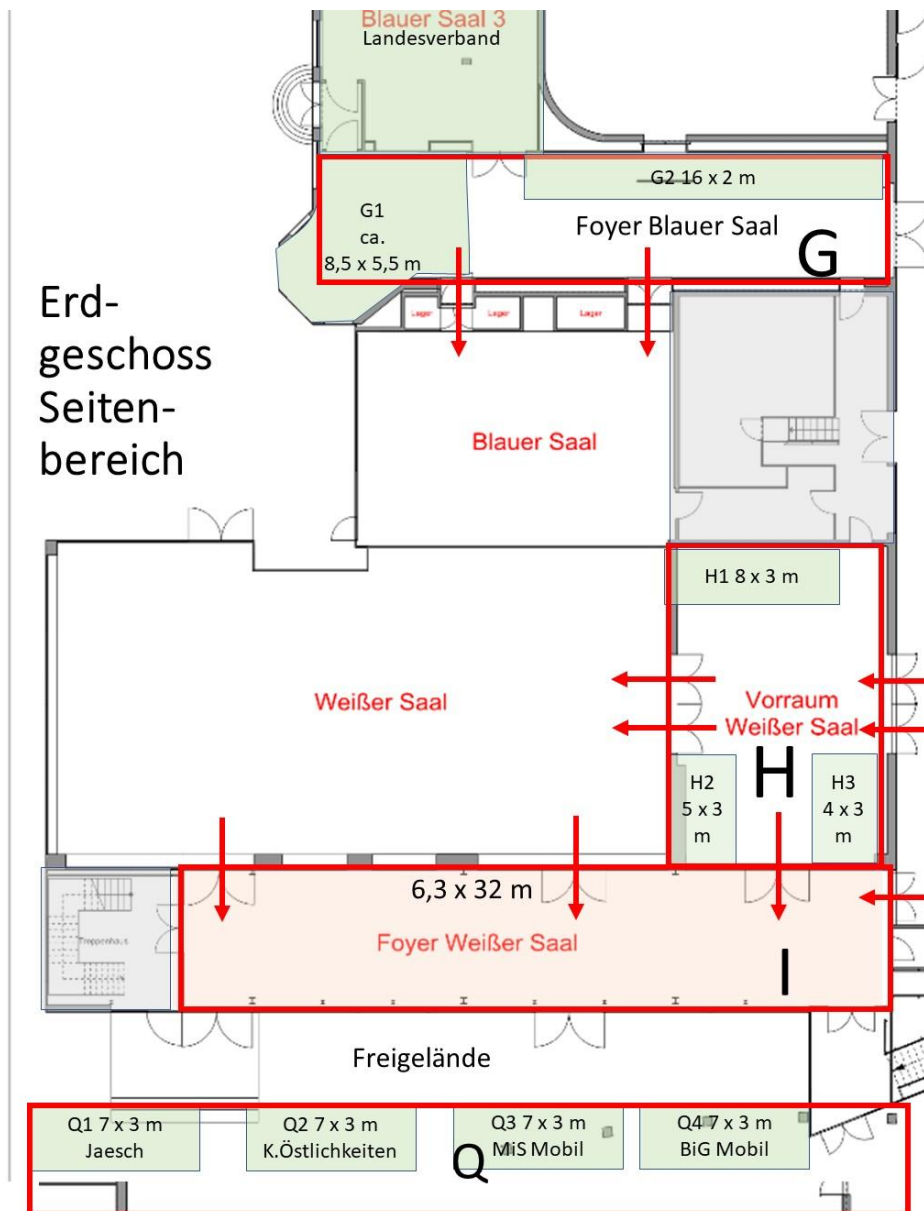

Erd-
geschoss
Seiten-
bereich

- G Foyer Blue hall**
- G1** ca. 8,5 x 5,5 m plus small bay
- G2** 16 x 2 m, exhibits 2 m depth, back wall

Blue hall 3: Landesverband WL

- H adjoining room White hall**
- H1** 8 x 3 m, exhibits 3 m depth, back wall
- H2** 5 x 3 m, exhibits 3 m depth, back wall
- H3** 4 x 3 m, exhibits 3 m depth, back wall

- I Foyer White hall**
geplant Apis e.V. Bücher, Videos, Saatgut, Refraktometer, Lesebereich etc.

- Q open-air exhibition area**
Market and information, sales trailers



Lageplan Apisticus-Tag



- 1 Congress Saal, 2 Congress Saal Foyer, 3 Top Congress, 4 Blauer Saal, 5 Weißer Saal, 6 Galerie, 7 Roter Saal, 8 Grüner Saal, 9 Nordfoyer,
- 10 Große Halle, 11 Südfoyer, 12 Messehalle Süd, 13 Forum Süd, 14 Messehalle Mitte, 15 Forum Nord, 16 Messehalle Nord, 17 P1
- Parkplatz Nord, 18 P2 Parkplatz Süd (Aussteller), 19 Verwaltung, 20 Tryp Congresshotel, P3 Stadtverwaltung jenseits des Alberslöher
- Wegs



Das Foyer

Der Congress Saal



Blick von der Empore Richtung Bühne.





Der Blaue Saal



Foyer Blauer Saal



Forum 1 Obergeschoss



Galerie Obergeschoss